



(page 1 of 4)

Airworthiness Directive: #117

Date: June 15, 2000

Subject: Anti-Deflection Pulleys

Compliance: Mandatory before next flight

Models Affected: S-17

It has been determined that your S-17 Stinger requires Anti-Deflection Pulleys. These locate on the top side of the control stick torque tube. (See photo)
Please install these prior to your next flight.

INSTALLATION OF THE 5/8" ELEVATOR PUSH PULL TUBE ANTI-DEFLECTION PULLEYS

1. Select the parts shown in the parts drawing.
2. Remove the existing eyebolt through the 5/8" push pull tube. Slip the welded aluminum fitting over the end of the push pull tube, so the crossing bushing is facing forward. Line up the 1/4" hole through the fitting with the hole in the push pull tube. Insert the new longer 1/4" eyebolt provided in the kit with the 1/4" thick washer under the eyebolts head. It is critical for link tube clearance, that the 1/4" thick washer is installed under the head of the eyebolt.
3. Install the pulleys to the pulley mounts using the 1/4" bolt. The pulleys must ride on top of the two 5/8" steel tubes welded to the side of the torque tube. Use 1/4" washer as required to shim the pulleys into position.
4. Adjust the elevator travel to establish at least 20 degrees down and 30 degrees up elevator. Remove the 1" end cap from the control stick torque tube or remove the glide and reduce its width if required to obtain elevator travel.
5. Check the installation for proper function by moving the control stick fore and aft. It should glide back and forth smoothly with resistance. If there is a lot of friction, check for free space between the pulley and steel tube. Also check the glides, the 5/8" aluminum push pull tube slides in for clearance. There should be no binding, the tube should glide freely through the gray plastic glides. Check all nuts and bolts for tightness before flying.

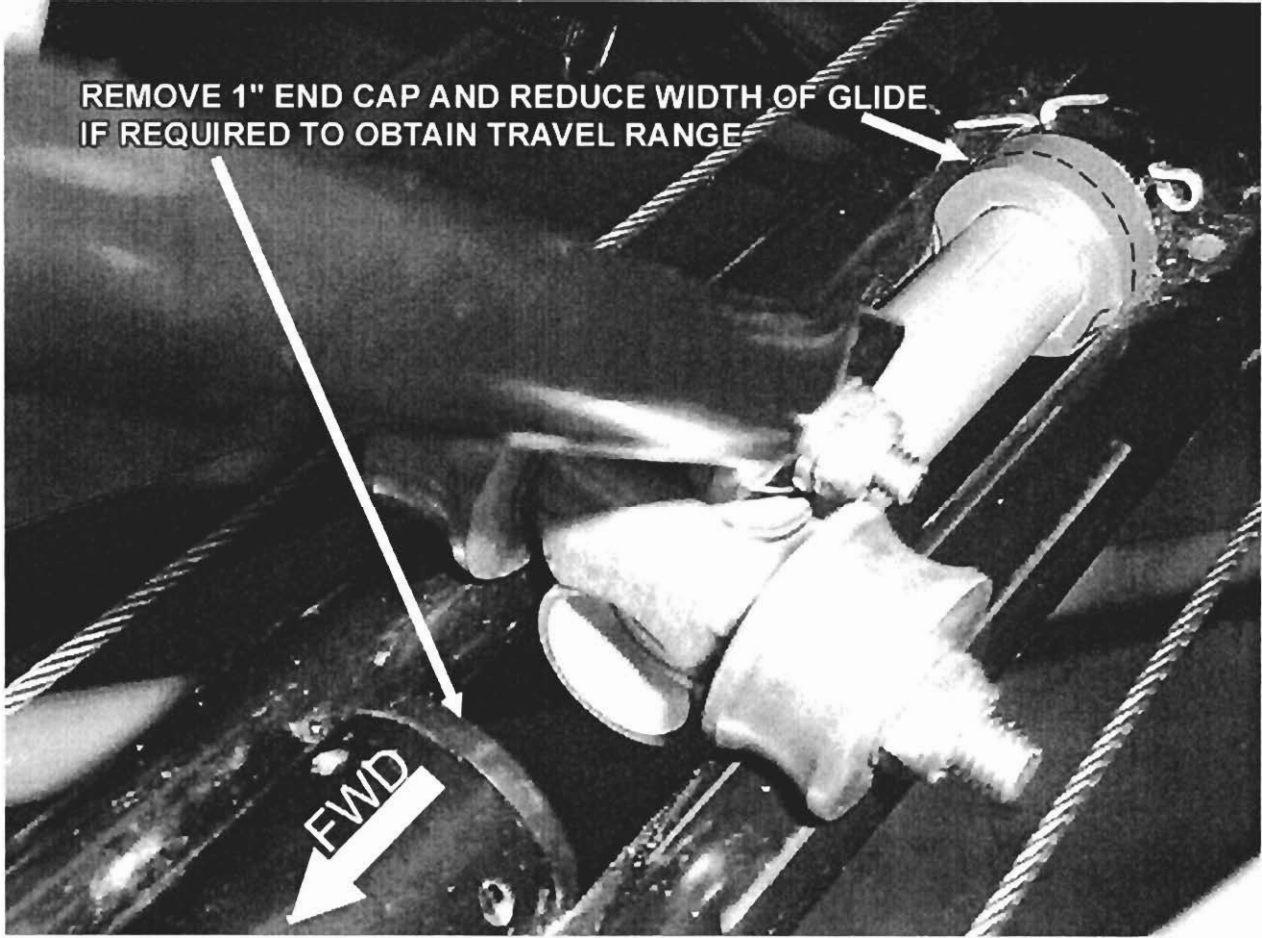

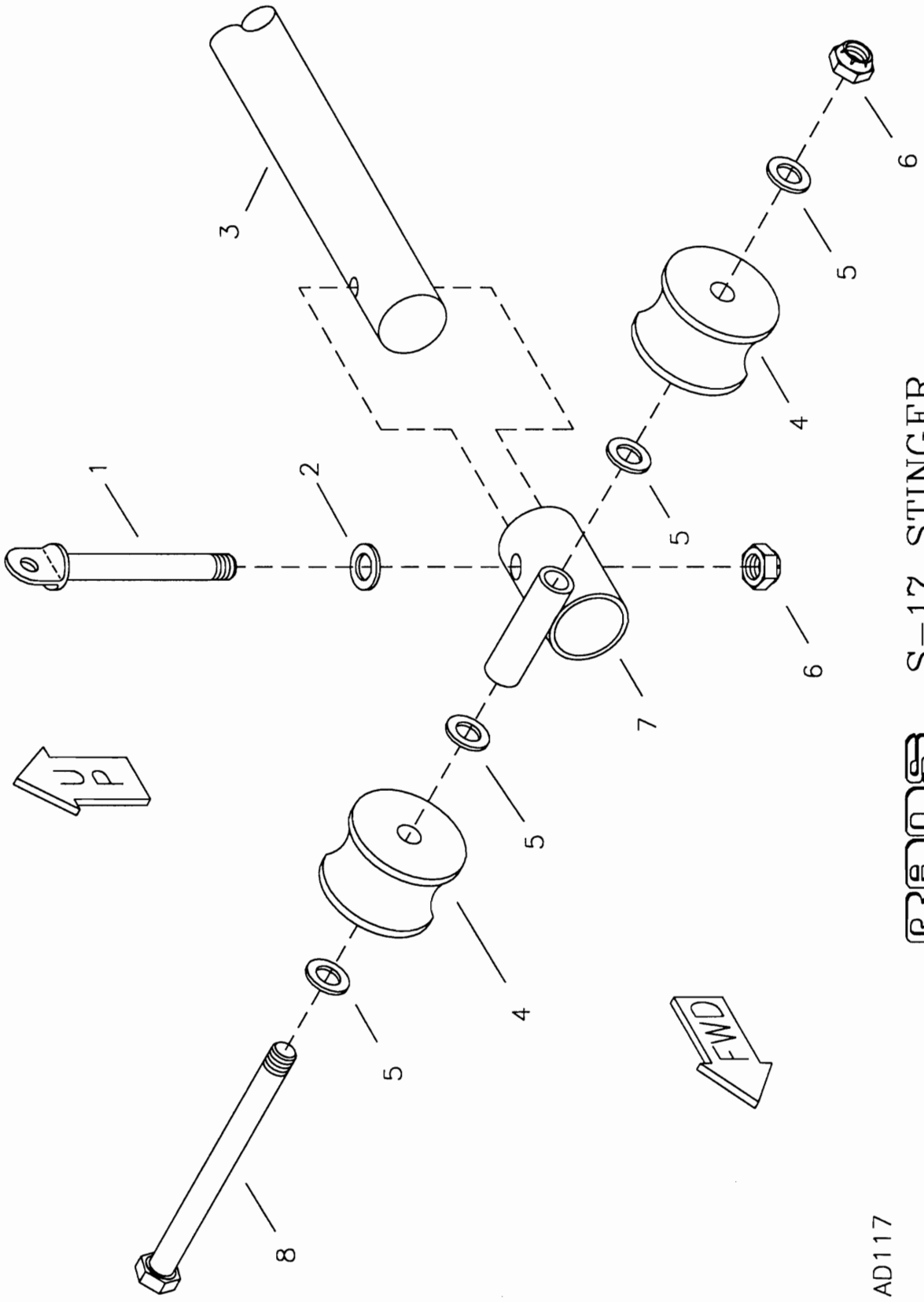

RRRAMES S-17 STINGER
ANTI-DEFLECTION PULLEYS

AD117

S-17 Stinger - Anti-Deflection Pulleys

#	DESCRIPTION	PART NUMBER	QUANTITY
1.	1/4" Eyebolt	AN43B-11A	1
2.	1/4" Thick Washer	AN960-416	1
3.	Existing 5/8" Push Pull Tube *	----	0
4.	Pulley	CS-PULL	2
5.	1/4" Thin Washer	AN960-416L	4
6.	1/4" Shear Nut	AN364-428A	1
7.	Pulley Mount	CS-PULMT	1
8.	1/4" Bolt	AN4-23A	1

*Existing Hardware.